

# MEMORY CARE

Azura of Mukwonago's memory care households offer personalized, purpose-filled Alzheimer's and dementia care focused on retaining abilities and enhancing quality of life. Where many senior living homes feel more like medical centers or private hotels, Azura's Memory Care and Assisted Living communities are intentionally designed using our Household Model — ensuring that every resident has a space where they feel safe, familiar, comfortable, and engaged in a life filled with personalized moments of joy.

Each resident's private suite can be customized with their personal items, making it feel like home. Additionally, utilities, Wi-Fi, bedding, linens, housekeeping, and laundry services are included. Their care will be individually tailored to meet their specific needs, delivered by our outstanding 24-hour care team trained in evidence-based, scientifically validated dementia care practices. This approach aligns with our exclusive MOSAIC philosophy, which focuses on engagement and personalized care. Each household has a Quality of Life team member to enhance engagement through holistic therapies of activity, creativity, reminiscence, sensory, cognitive, and more.

Other highlights include personalized management of medications and expressions with a high caregiver to resident ratio, healthy food options including nutritious snacks and dietician-approved meals. We offer customized assistance with grooming, bathing, dressing, incontinence, can use mechanical lifts. We are a pet-friendly atmosphere for those who enjoy animals.

Residents will experience a warm, loving home designed to enhance quality of life and independence, while ensuring enhanced security through the use of alarmed doors, R-Care Emergency Response System, and on-site/on-call nurse oversight so that you can sleep at night knowing your loved one is safe.

Prices range between \$8,250 - \$12,150 depending on room style and care tier.

Care tier based on a personalized assessment  
One time community fee of \$3,000

Do you need a break, or want to do a trial run with your loved one? Azura offers short-term *respite* stays for \$350 a day for 14 to 28 days.

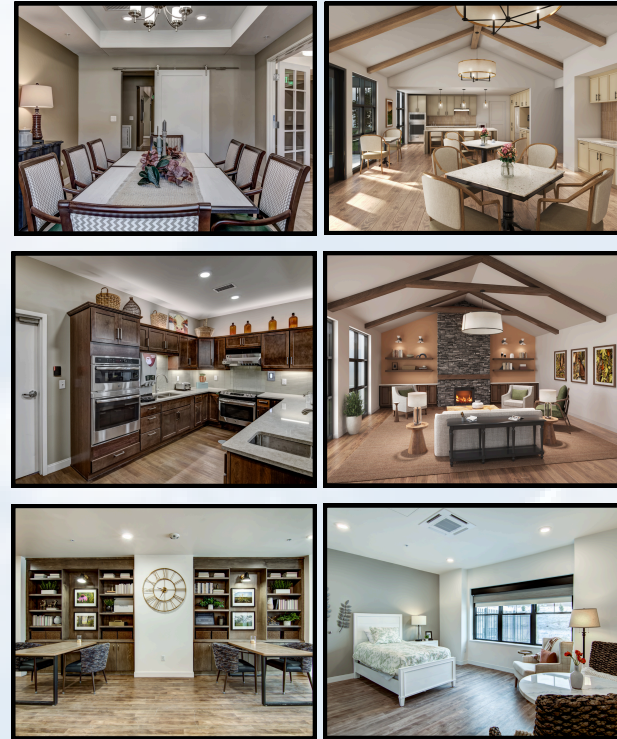

# ASSISTED LIVING

We offer two vibrant assisted living households that provide a holistic approach, empowering residents to live life to the fullest using our MOSAIC philosophy and training. We have ensured that from the paint on the walls to the layout of the homes and grounds, every aspect has been carefully chosen to provide our residents with the best possible experience.

Each resident's private apartment can be personalized with their belongings, with utilities, Wi-Fi, bedding, linens, housekeeping, and laundry services included. Their care will be also be tailored to their personal needs and provided by our exceptional 24-hour team. Every household includes a Quality of Life team member dedicated to fostering engagement through a range of holistic therapies such as activities, creativity, reminiscence, sensory experiences, cognitive tasks, and more.

Additional features include tailored medication management and attentive care with a high caregiver-to-resident ratio, as well as healthy dining choices with nutritious snacks and dietician-approved meals that cater to individual preferences. There is also personalized help with grooming, bathing, dressing, incontinence care, and the use of mechanical lifts. Plus, the environment is pet-friendly, with included walking paths and a pet area, welcoming those who cherish the company of animals.

At Azura, residents will find a warm and caring home that enhances their quality of life and independence, complete with increased safety measures such as the R-Care Emergency Response System and continuous nurse oversight available both on-site and on-call. This ensures that you can rest easy at night, knowing your loved one is secure and well-cared for.

Rest assured, if your loved one needs to make the transition to memory care in the future, our two memory care households are in the same building to ensure a smooth transition.

Prices range between \$5,730 - \$9,840 depending on room style and care tier.

Care tier based on a personalized assessment  
One time community fee of \$3,000

Do you need a break, or want to do a trial run with your loved one? Azura offers short-term *respite* stays for \$350 a day for 14 to 28 days.

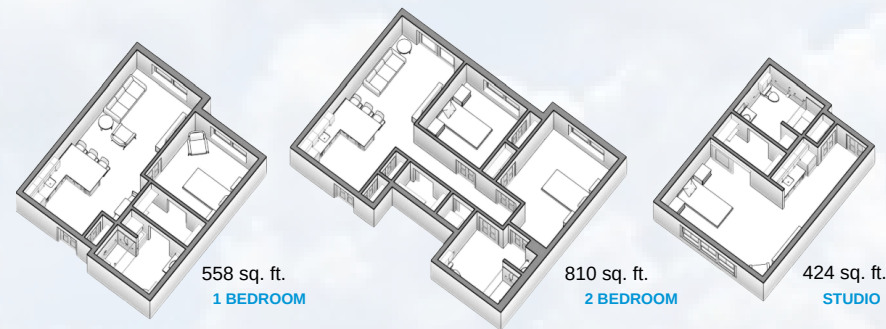
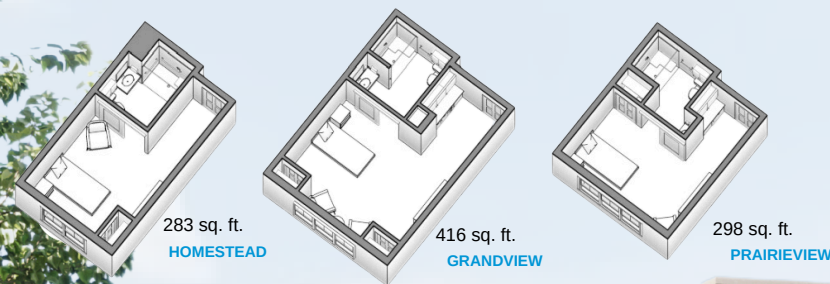



## ENJOY PERSONALIZED CARE AND SERVICES THAT GO FAR BEYOND WHAT OTHER MEMORY CARE AND ASSISTED LIVING HOMES PROVIDE

### PHYSICIAN SERVICES

We are proud to provide on-site physician visits for our residents that focus on high quality, personalized, and confidential medical care. We also work with a laboratory and x-ray company that comes right to our Azura home for blood draws, x-rays, ultrasounds, swallow studies, and more.

### PHYSICAL, OCUPATIONAL AND SPEECH THERAPY

Therapy is provided to our residents in the comfort of their Azura home. These services are prescribed by the doctor, and typically covered by Medicare or insurance.

### DNA TESTING

Our commitment to innovation is proven through our use of GeneSight®'s cutting-edge DNA testing to gauge the effectiveness of medications for each resident and to ensure proper dosing and efficacy.

### PSYCHIATRY SERVICES

Our group of highly experienced psychiatrists and nurse practitioners provide on-site psychiatric consultation to our residents. This provides better communication with our team and a better understanding of your loved one's care.

### PODIATRY SERVICES

We offer podiatry services, and the podiatrists come on site to address needs and concerns for your loved one.

### HOSPICE AND PALLIATIVE CARE

Hospice and palliative care is available at Azura, and your loved one can live with us through the end of their life. Our team members are trained on how to use mechanical lifts and other equipment to make transfers easier and make residents as comfortable as possible while keeping their dignity.

### SALON AND SPA SERVICES

Enjoy a spa day without ever leaving the comfort of your home. We offer in-home beauticians for men and women's hair care, shaving, waxing, nail care and more to ensure our residents are always looking and feeling their best.



GET SOCIAL WITH US AND FOLLOW US ON FACEBOOK FOR PROGRESS UPDATES AND ANNOUNCEMENTS

## OPPORTUNITIES FOR THE COMMUNITY

\*\*you do not need to be a part of Azura to participate in these programs

### T.I.M.E. PROGRAM

Studies have proven that people who engage in consistence brain stimulation can significantly lower the risk of dementia & improve cognition function of the brain.

**COMING SOON!**

### DEMENTIA SUPPORT GROUP

Meets 1x a month. Supporting families, friends & caregivers to those who are on a journey with a loved one who has dementia. You will connect with others who share similar experiences, learn techniques on how to work with challenging situations.

**COMING SOON!**

### MEMORY CAFE

Meets 1x a month. Being socially & mentally active is a great way to keep your brain sharp. We meet as a group for those with memory concerns and we encourage loved ones to attend alongside as we are in this together.

**COMING SOON!**

### VIRTUAL DEMENTIA TOUR

Experience what it's like to live with dementia by walking in their shoes. This life-changing simulation will provide you with a better understanding of the challenges those with dementia face, equipping you with empathy, and the tools you need to provide better care. The Virtual Dementia Tour, created by P.K. Beville, is a scientifically proven method of building a greater understanding of dementia through the use of patented sensory tools and instruction.

**COMING SOON!**

# AZURA®

MEMORY CARE • ASSISTED LIVING

215, 217, and 221 Chapman Farm Blvd, Mukwonago, WI

### COMING TO MUKWONAGO, WISCONSIN

Azura Memory Care and Assisted Living is proud to be building another exceptional home in the Mukwonago, WI community! Our Mukwonago home is purposely designed to meet the needs of our residents through specialized support and programing to fulfill their unique social, mental, physical, emotional and spiritual needs.

### OUR APPROACH

Azura is dedicated to providing the highest quality of empathetic, knowledgeable, and transformative care to each of our residents. This level of quality care doesn't just happen by accident.

Azura's MOSAIC philosophy is based on our exclusive training and engagement programming, which ensures that our teams not only provide high-quality care, but also exceptional and personalized engagements that result in magical MOSAIC Moments and radiant smiles! Azura's Memory Care and Assisted Living communities are intentionally designed using our Household Model — ensuring that every resident has a space where they feel safe, familiar, comfortable, and engaged in a life filled with personalized moments of joy.



Josh McClellan, Founder and CEO



### WHO WE ARE

Wisconsin-based and family owned, Azura Memory Care and Assisted Living created its name from the Latin word for "blue sky". It fits nicely with the clear, crisp skies found throughout Wisconsin where Azura's communities are based, with 15 other locations. It also speaks to our founder's desire to create an inspiring company with a healthy and positive environment for our guests, residents and team members. Josh McClellan, founder and CEO of Azura, has spent more than 35 years in the healthcare industry. He started the company in 2008 with a vision to **transform the culture of care.**

### CORE VALUES REFLECT OUR CARE

At Azura, we promise each resident will experience a personalized MOSAIC of exceptional care and engagement, based on our core values...

1. We are **COMMITTED** to the care of our residents and team members
2. We **LOVE** what we do and who we do it with
3. We encourage **INNOVATION** and creativity
4. We treat our residents with the utmost **COMPASSION**
5. We treat everyone with **KINDNESS**, dignity and respect

